

Main South Road Duplication Project (Stage 2)

Night Works - Southbound on and off ramps

We're doubling the capacity of Main South Road from Aldinga to Sellicks Beach to improve safety and make your journey more reliable.

The \$810 million Fleurieu Connections project is jointly funded by the Australian and South Australian governments.

What's happening

We'll be undertaking night works, ahead of opening the new southbound on and off ramps at the Aldinga Interchange.

How this affects you

From Tuesday 9 September 2025, works will be undertaken around the new Aldinga Interchange,

From 7pm Sunday 14 September (for approximately one week), Main South Road between Port Road and the Aldinga Bridge will be temporarily closed each night, with traffic able to detour via Aldinga Beach Road, How Road and Port Road. Main South Road will reopen each morning at 7am.

From 7pm Sunday 28 September, Aldinga Road between Main South Road and Plains Road will be closed. **From 10.30pm Sunday 28 September**, Main South Road between Port Road and Colville Road will also temporarily close. During this time a detour will be in place. See maps overleaf for more details. Access for emergency services will be facilitated at all times.

During the week commencing Monday 29 September southbound traffic will begin using the new on and off ramps, weather permitting.

Stay up to date with changed traffic conditions, works updates and more by registering for SMS updates. Visit www.fcalliance.com.au/SMS for more information.

When

From Tuesday 9 September 2025 until late September 2025

Hours of work

Night works between 7pm and 7am

Where

Main South Road, Aldinga Road and Aldinga Beach intersection

More information

www.fcalliance.com.au

info@fcalliance.com.au

1300 896 826 (24hrs)



Safer access onto and across Main South Road



Improving safety and making your journey more reliable



Supporting over 400 jobs each year



Australian Government

BUILDING AUSTRALIA



Government of South Australia

Department for Infrastructure and Transport

SA IS BUILDING
→

Delivered by

FLEURIEU CONNECTIONS ALLIANCE

Temporary Road Closure: Sunday 14 September 2025 for one week

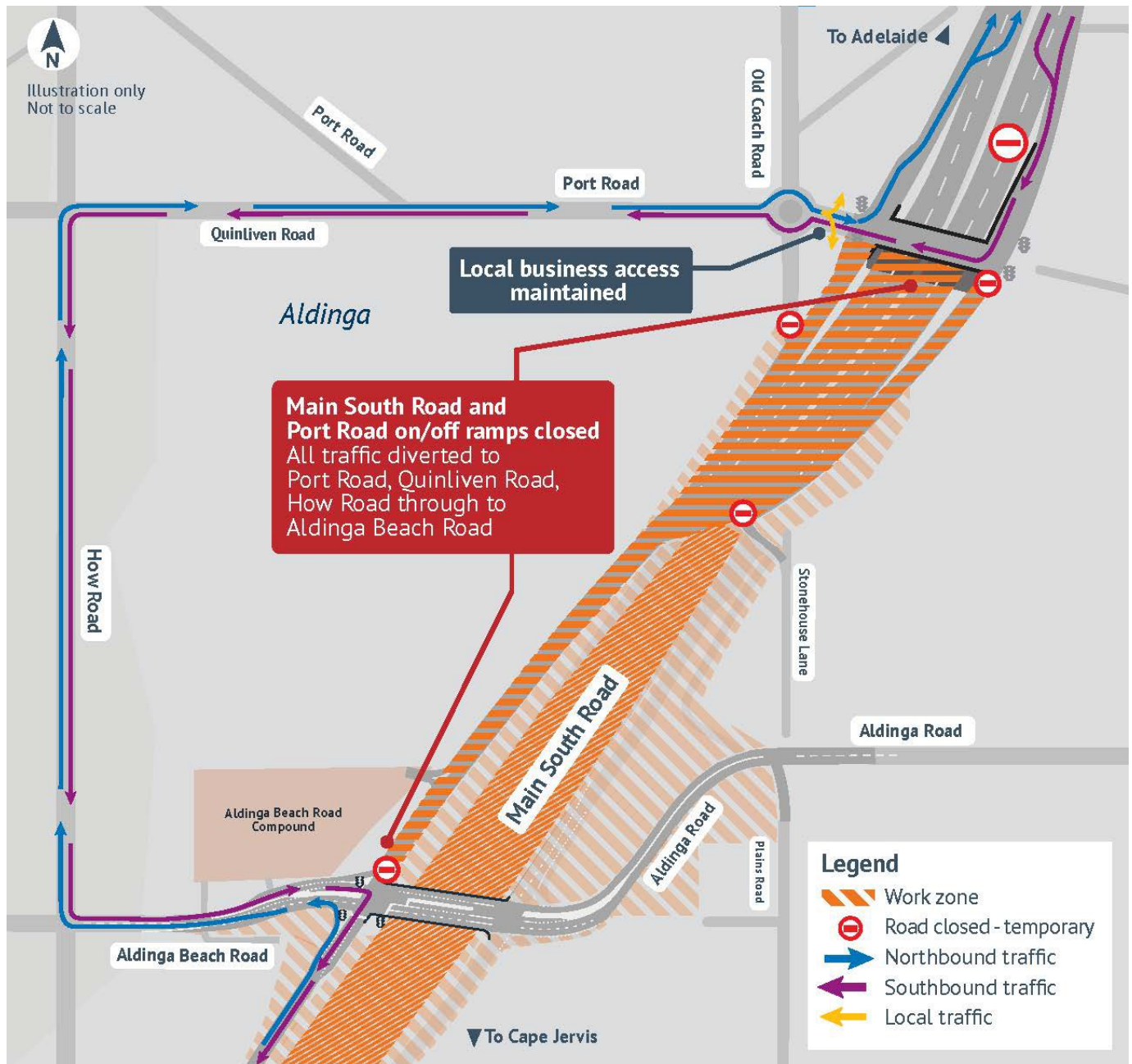

From Sunday 14 September for approximately one-week, Main South Road between Port Road and Aldinga Bridge will be temporarily closed for night works. Works will be undertaken between 7pm and 7am with Main South Road reopening each morning. During this time a detour will be in place via Aldinga Beach Road, How Road and Port Road.

Temporary Road Closure: Sunday 28 September from 7pm until 7am

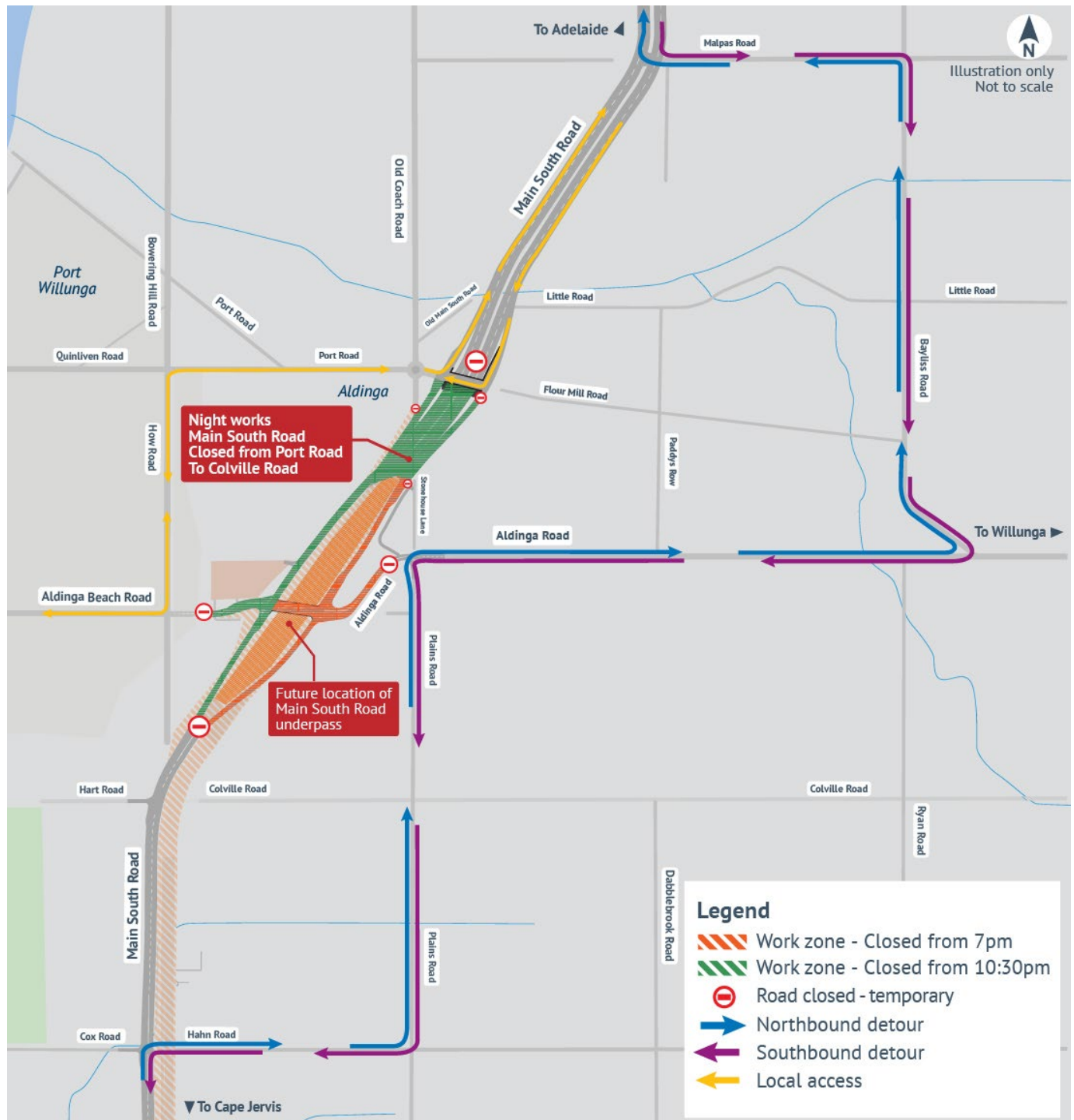

From 7pm Sunday 28 September 2025, Aldinga Road between Main South Road and Plains Road will be temporarily closed.

From 10:30pm Sunday 28 September, Main South Road between Port Road and Colville Road will also temporarily close. During this time a detour will be in place via Malpas Road, Bayliss Road, Aldinga Road, Plains Road and Hahn Road.

During the week commencing Monday 29 September southbound traffic will begin using the new on and off ramps, weather permitting.