

MAIN SOUTH ROAD, SHERRIFF ROAD AND COMMUNICATION ROAD INTERSECTION

As part of the Main South Road Duplication project, the upgraded Sherriff and Communication Road intersection will improve safety for local traffic.

What to expect

Changes to traffic arrangements include:

Southbound traffic on Main South Road can:

- turn left into Communication Road via a dedicated turning lane;
- turn right into Sherriff Road via a dedicated turning lane.

Northbound traffic on Main South Road will:

- turn right into Communication Road via a dedicated turning lane;
- turn left into Sherriff Road via a dedicated turning lane.

Traffic restrictions include:

- traffic exiting Communication Road cannot turn right onto Main South Road;
- traffic cannot cross from Communication Road to Sherriff Road, or vice versa;
- traffic exiting Sherriff Road cannot turn right onto Main South Road.

U-turns:

- U-turn functions are available for traffic in both directions at the signalised intersections on Tatchilla Road and Port Road;
- for southbound traffic, a U-turn facility is located between Branson Road and Malpas Road; and
- for northbound traffic, a U-turn facility is located between Thomas Road and Sherriff Road.

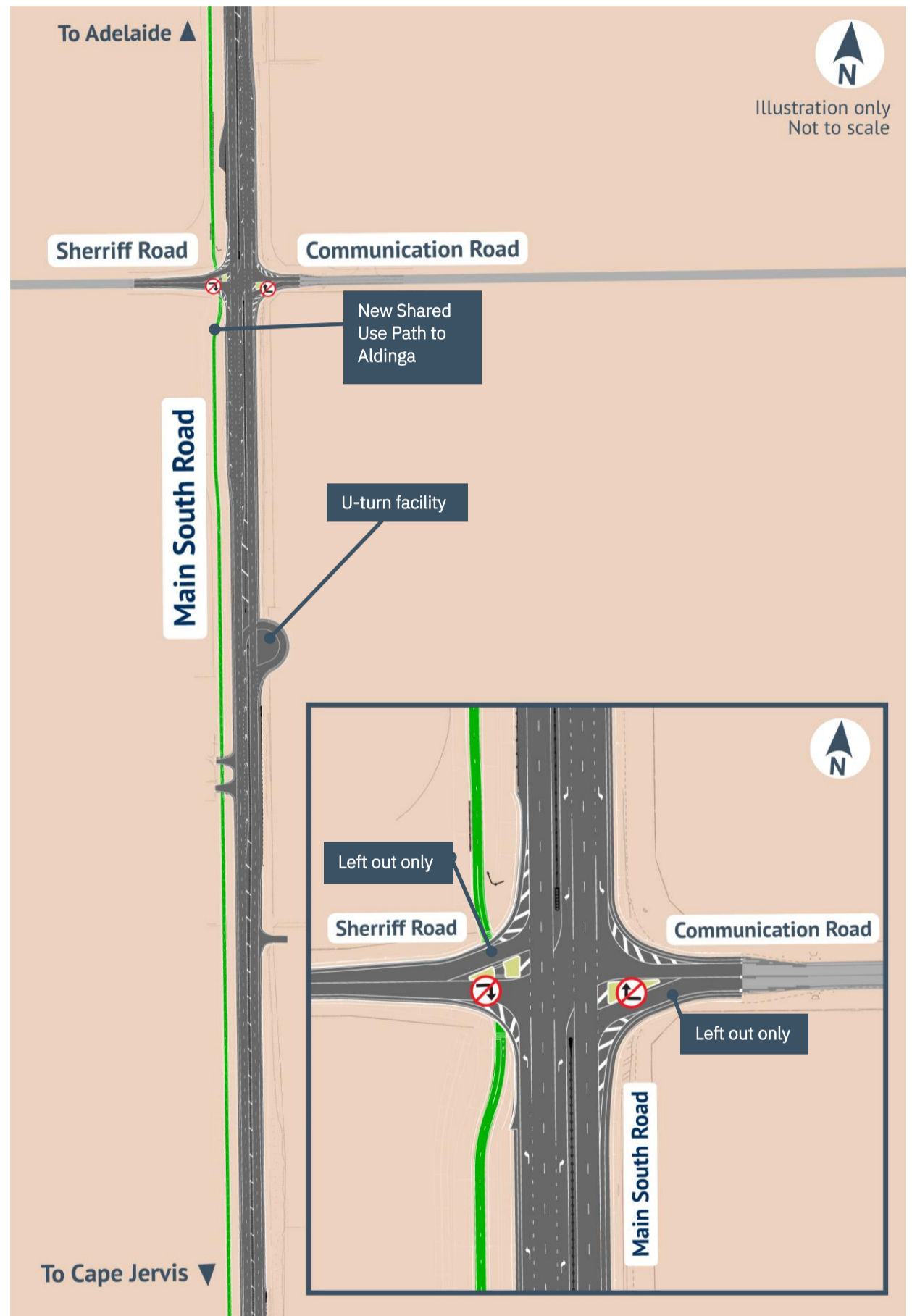

Find out more

Scan this QR code or contact the FCA team using the details below:



 1300 896 826

 info@fcalliance.com.au

 www.fcalliance.com.au



Australian Government



Government of South Australia