

MAIN SOUTH ROAD AND LITTLE ROAD INTERSECTION

As part of the Main South Road Duplication project, the upgraded Main South Road and Little Road intersection will improve safety for local traffic.

What to expect

Changes to traffic arrangements include:

- southbound traffic will travel onto Little Road via the Port Road off ramp;
- northbound traffic from Main South Road cannot turn right into Little Road;
- traffic exiting Little Road will turn left onto the Port Road off ramp road and use the Port Road intersection to travel in the desired direction.

U-turns:

- U-turn functions are available for traffic in both directions at the signalised intersections on Tatchilla Road and Port Road;
- for southbound traffic, a U-turn facility is located between Branson Road and Malpas Road; and
- for northbound traffic, a U-turn facility is located between Thomas Road and Sherriff Road.

Find out more
Scan the QR code or
contact the project team
using the details below

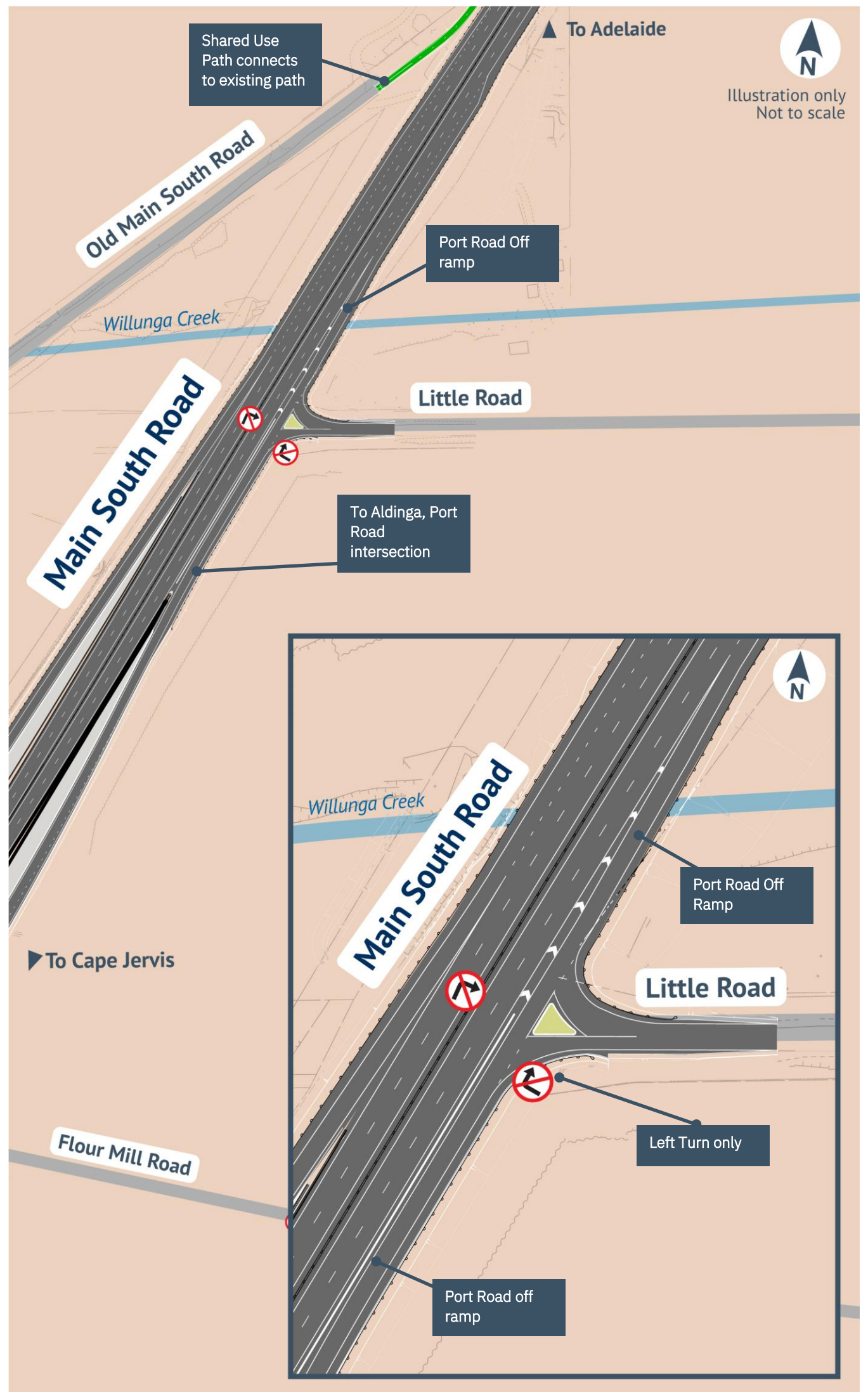

1300 896 826

info@fcalliance.com.au

www.fcalliance.com.au



Australian Government



Government of South Australia